

# Nectar Large Half Lampshade Assembly

Please read through all of the instructions and carefully look at the photos before assembling your Nectar shade.

## Components supplied

- 11x Part Assembled Honeycomb Panel
- 1x 210mm Pendant Ring with Washer Attachment
- 1x 680mm Pendant Ring

## Important Notes

- These shades are for interior use only.
- Use only a low-heat, compact fluorescent (energy-saving) E26 or LED light bulb. Standard incandescent light bulbs will damage your Nectar shade.
- Max 20 watt compact fluorescent light bulb or globe, warm white.
- Honeycomb panels should be part assembled in 11 sets of 2 panels.

**CFL**  
Bulb



**CFL or LED**  
Globe

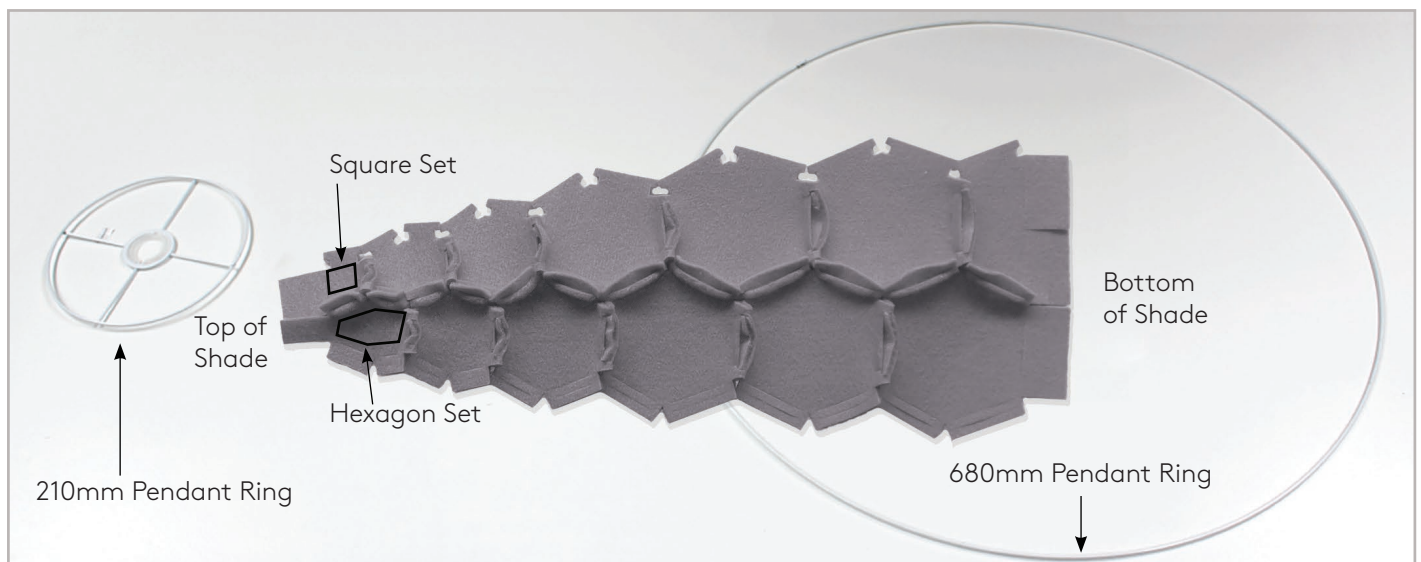

## Step 1

Place the two sets of strips (11 strips in each set) with the seam side facing up onto a clean surface. Make sure you also have the other items supplied in the kit.

Image 02



Image 03



Image 04



## Step 2

Pick up one of the strips making sure the fluffy side is still facing down. Starting with one of the middle tongues at the top of the panel **image 05**, feed the tongue under slot two and up through slot one (furthest slot from tongue) **image 06**. Firmly pull the tongue all the way through **image 07**.

Image 05

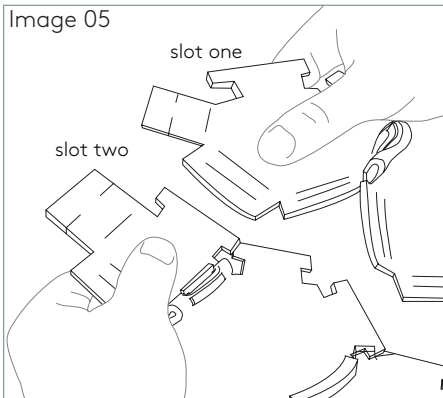

Image 06

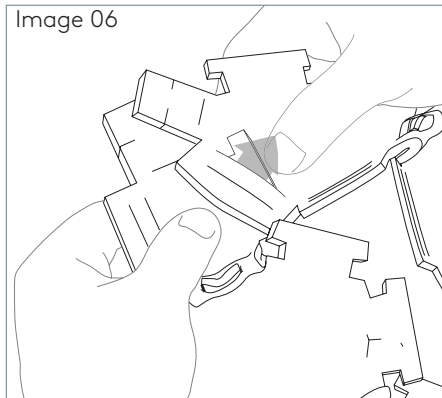
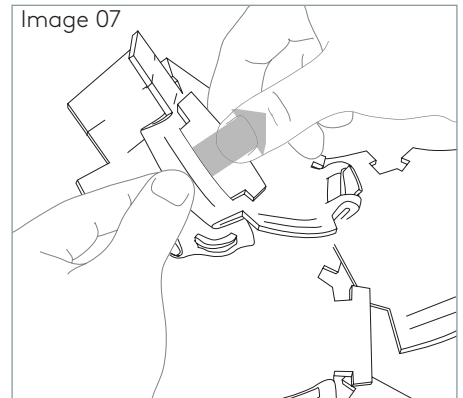

Image 07



## Step 3

Now feed the tongue back through slot two **image 08** firmly pulling it all the way through **image 09**. It should look like **image 10** when completed.

Image 08

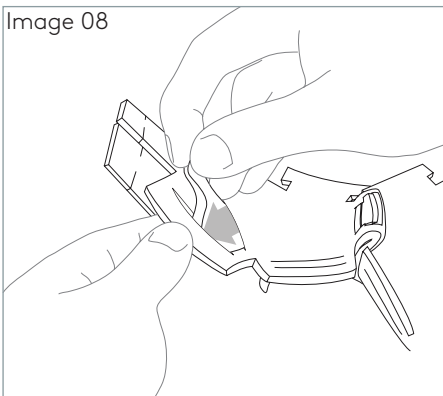

Image 09

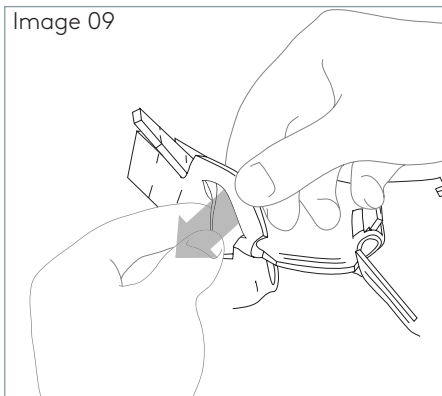
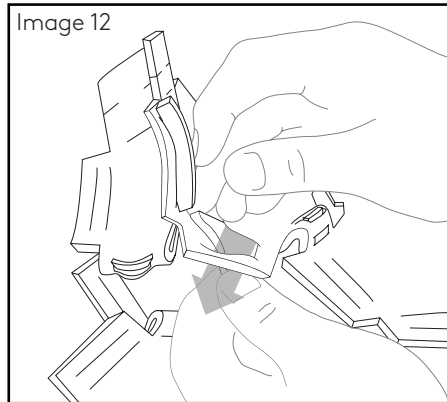
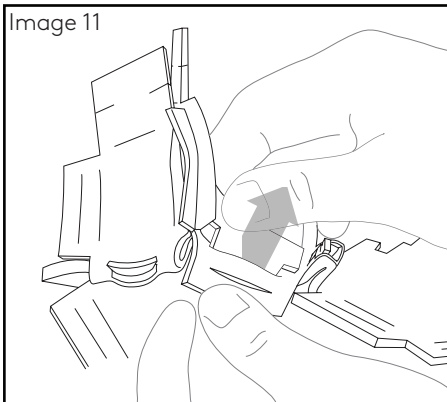

Image 10



## Step 4

Continue onto the next tongue feeding it under then through slot one from underneath, firmly pulling it all the way through **image 11**. Now feed the tongue back through slot two firmly pulling it all the way through **image 12**. It should look like **image 13** when completed. Continue this all the way down the seam between the two strips.



## Step 5

You should have 5 sets of these (four strips joined together) **image 14**, and 1 set of two strips joined together. Make sure you have alternating square and hexagon shapes at the top **image 15**. Repeat steps 5 through 7 to complete your shade.

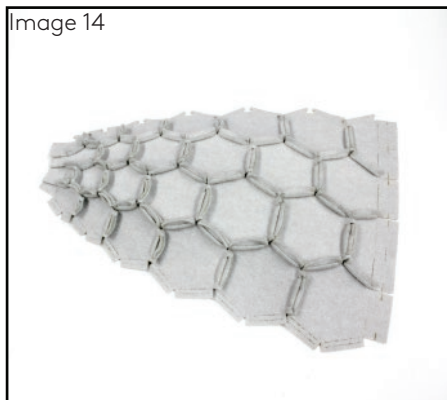

## Step 6

Let's put the large ring on the bottom of the shade. Turn the shade upside down and place the ring on the inside of the shade. Pull one of the large tongues over and under the ring and through the slot, so it sticks through to the outside of the shade **image 16**. Now rotate the shade 180° and pull the opposite large tongue over and under the ring and through the slot **image 17**. Do this all the way around the shade; it should look like **image 18**.

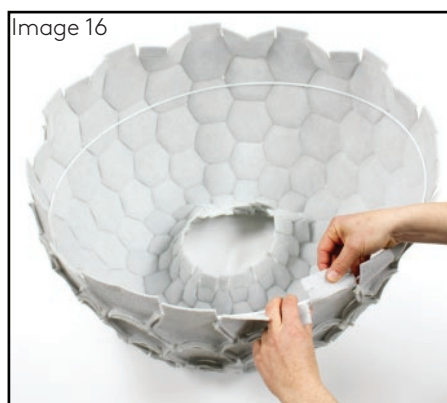



# Nectar Large Half Lampshade Assembly

pln.

## Step 7

Now flip the shade onto its bottom ring, put the smaller ring on the inside of the shade and pull one of the large tongues over the ring **image 19**, then under the ring **image 20**, and through the slot, so it sticks through to the outside of the shade **image 21**. Now rotate the shade 180° and do the same again with the opposite large tongue. Continue this all the way around the shade with the large tongues only.

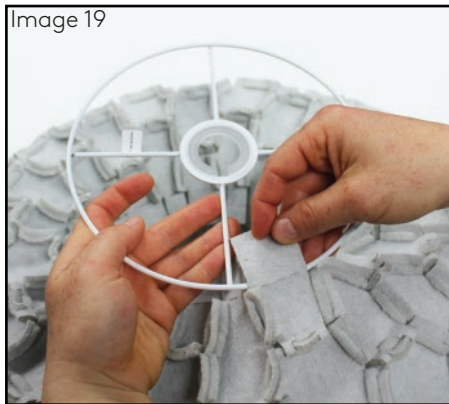

## Step 5 (wool needle or small screw driver or tweezer required for this step)

Now using a wool needle feed the small tongue over and under the ring and through the slot **image 22**. Once the tongue shows through the slot pull it through with your fingers or use the tweezers to pull it all the way through **image 23**. Do this on all the remaining small tongues making sure the tongues are evenly spaced around the ring. It should look like **image 24** when completed.

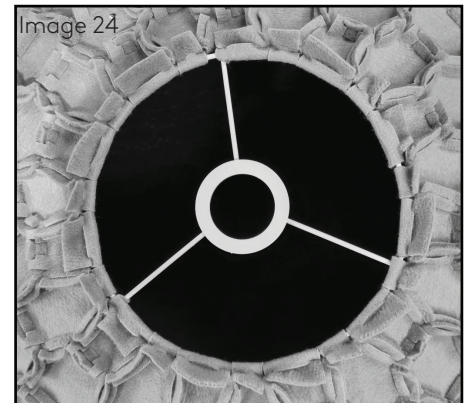

## Step 9

Congratulations your shade is complete. Now you can hang it from either a ceiling lamp holder **image 25**, or a hanging flex **image 26**. Once hung you can insert your recommended bulb. See first page of instructions for bulb recommendation. You can now turn it on and enjoy your Nectar.

