

# Nectar Full Lampshade Assembly

Please read through all of the instructions and carefully look at the photos before assembling your nectar shade.

## Components Supplied

- 6x Part Assembled Honeycomb Panels
- 1x 100mm Pendant Ring with Washer Attachment
- 1x 100mm Pendant Ring
- 1x Plastic Wool Needle

## Important Notes

- These shades are for interior use only.
- Use only a low-heat, compact fluorescent (energy-saving) E27 or LED light bulb. Standard incandescent light bulbs will damage your Nectar shade.
- Max 20 watt compact fluorescent light bulb or globe, warm white.
- Honeycomb panels should be part assembled in 6 sets of 2 panels.

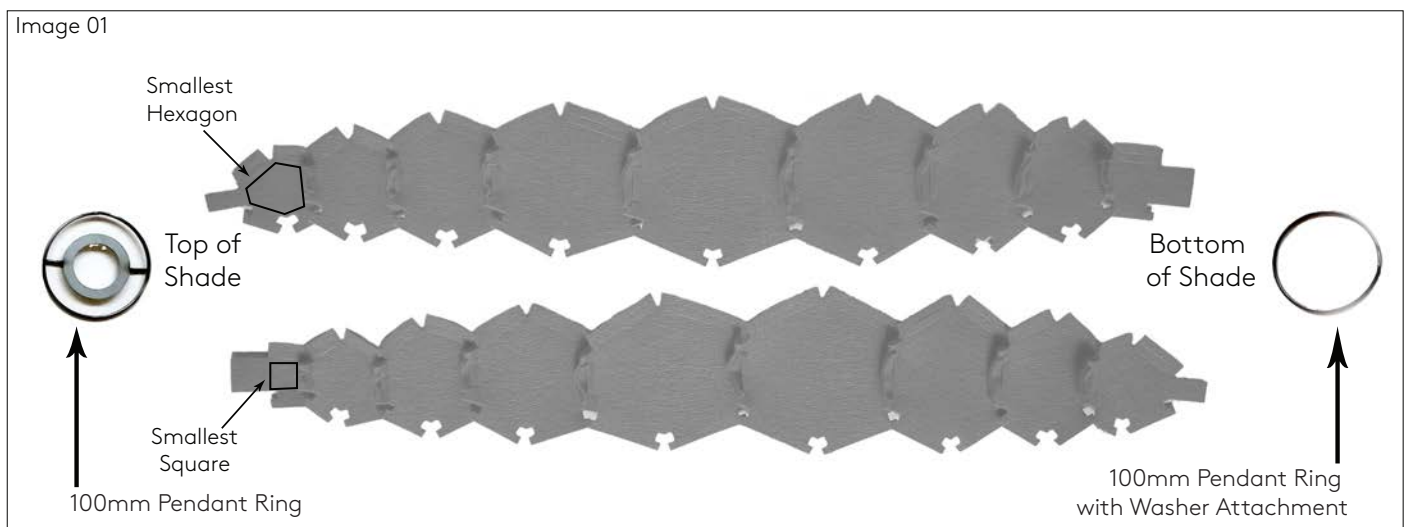
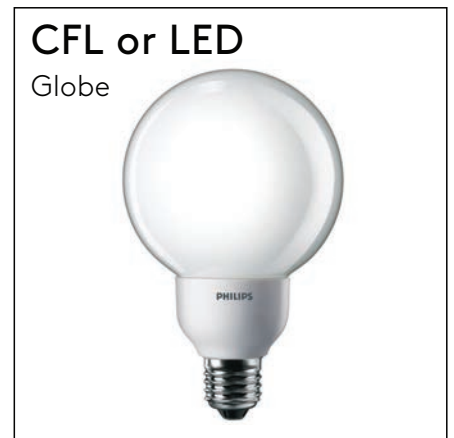
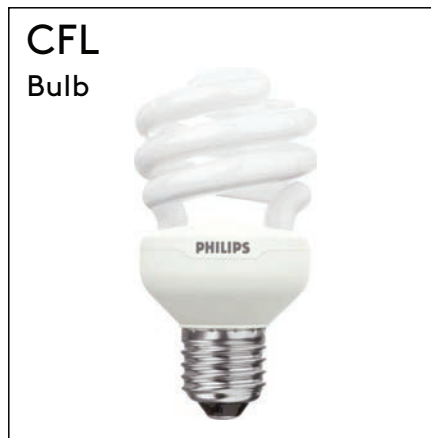
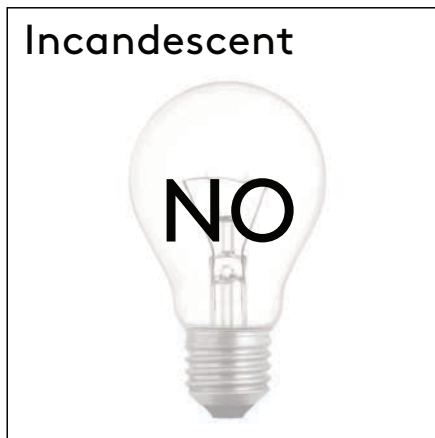

## Stage 1

### Step 1

Place the two sets of strips (six strips in each set) with the seam side facing up onto a clean surface image 01. Make sure you also have the other items supplied in the kit.

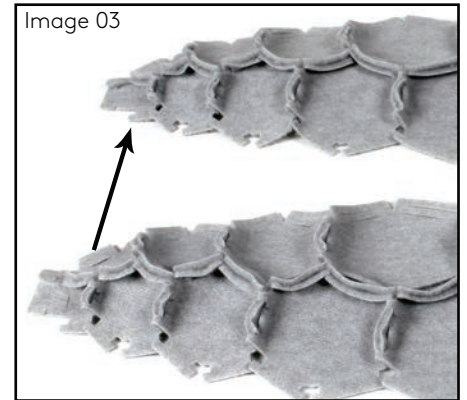
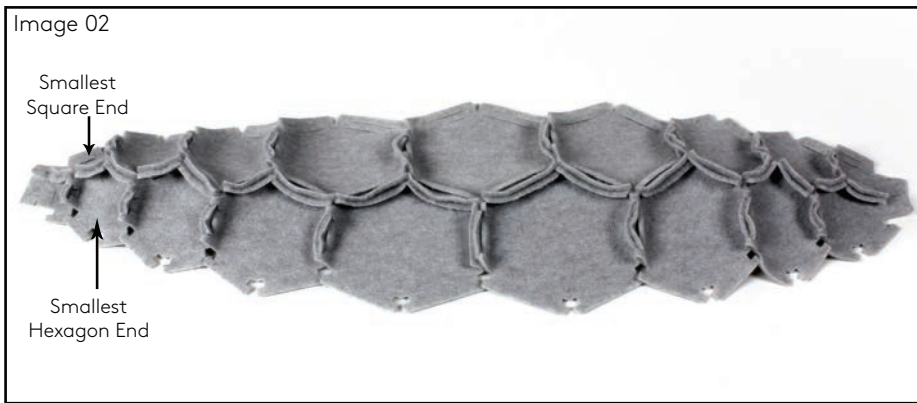

### Step 2

Pick up one of the part assembled panels making sure the raised seams are facing up. Starting with one of the middle tongues image 04, feed the tongue under slot two and up through slot one (furthest slot from tongue) image 05. Firmly pull the tongue all the way through image 06.

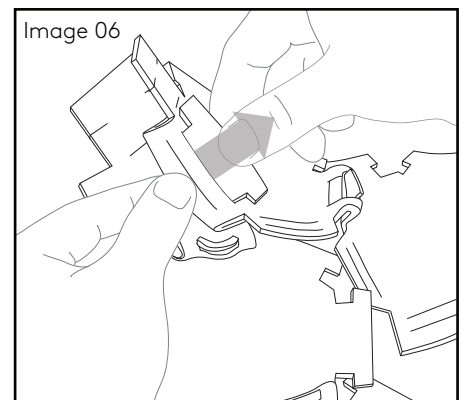
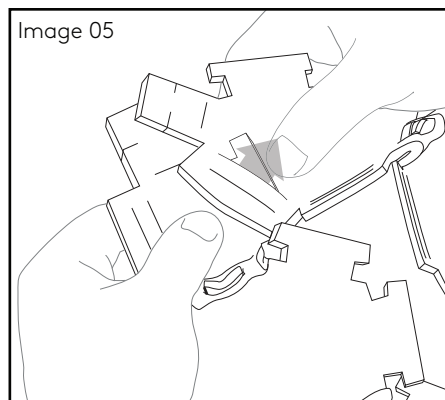
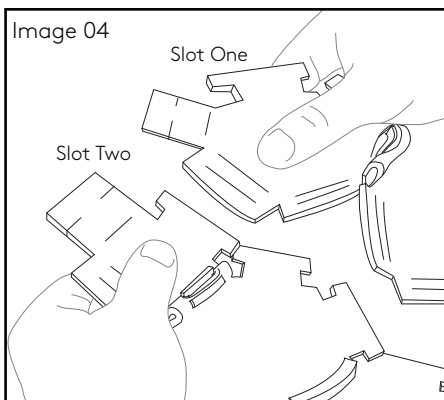

### Step 3

Now feed the tongue back through slot two image 07 firmly pulling it all the way through image 08. It should look like image 09 when completed.

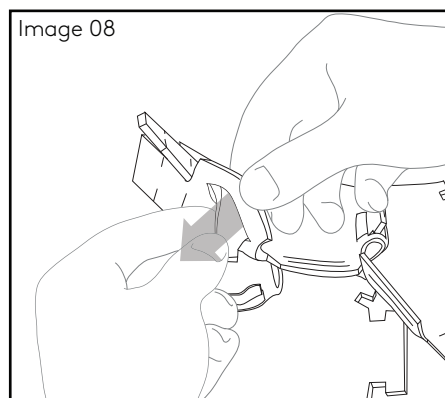
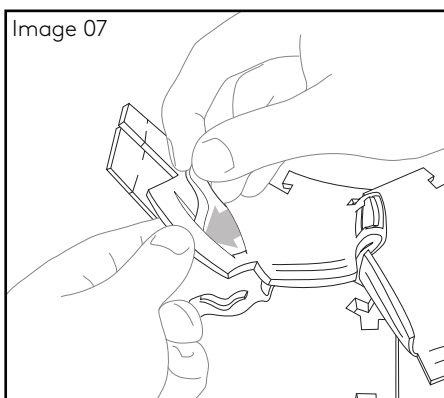

## Step 4

Continue onto the next tongue feeding it under then through slot one, firmly pulling it all the way through image 10. Now feed the tongue back through slot two firmly pulling it all the way through image 11. It should look like image 12 when completed. Continue this all the way down the seam between the two strips.

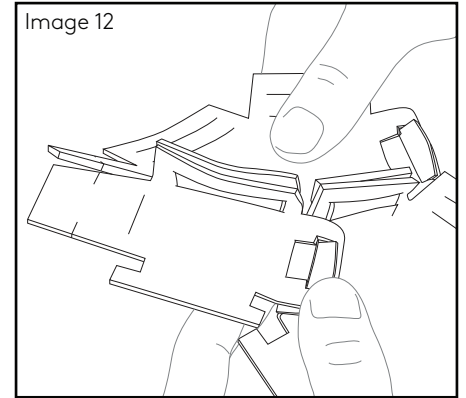
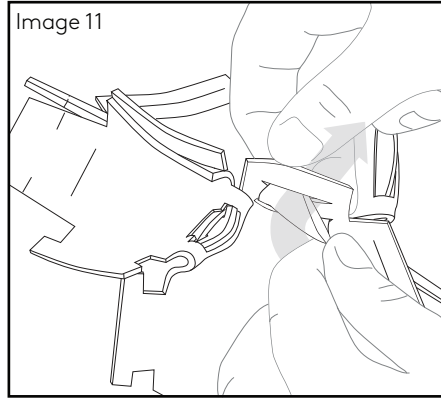
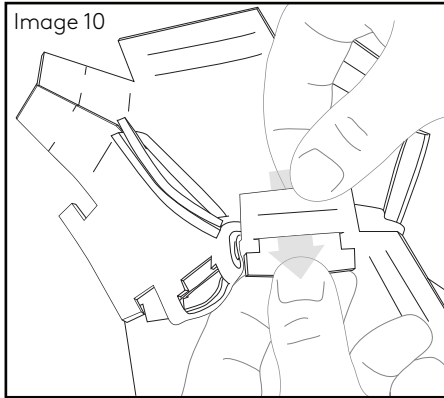

## Step 5

Make sure when joining these strips together that you have alternating smallest square and smallest hexagon shapes at the top image 13. Once these six larger strips are joined into four even bigger strips image 14, repeat steps 2 through 4 to complete your shade.

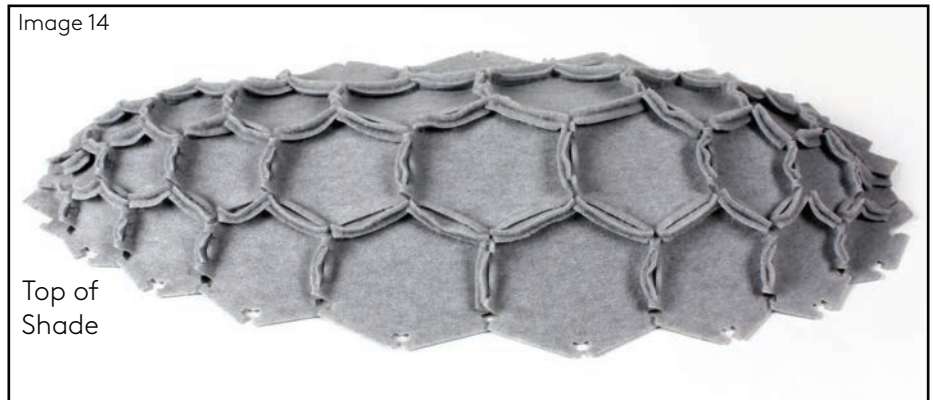
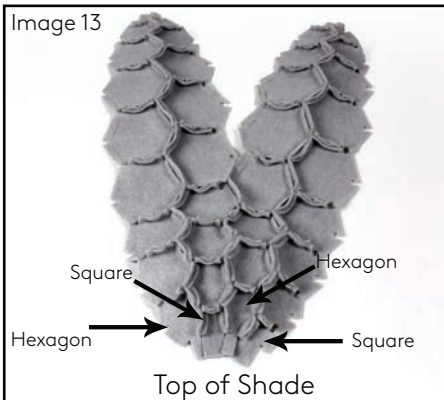

## Stage 2

### Step 6

The shade should now look like image 15. Starting with the hole at the bottom, turn the shade upside down, place the small ring on the inside of the hole and pull one of the large tongues over and under the ring and through the slot, so it sticks through to the outside of the shade image 16. Rotate the shade 180 degrees and pull the opposite large tongue over and under the ring and through the slot. Continue this on all the large tongues only image 17.

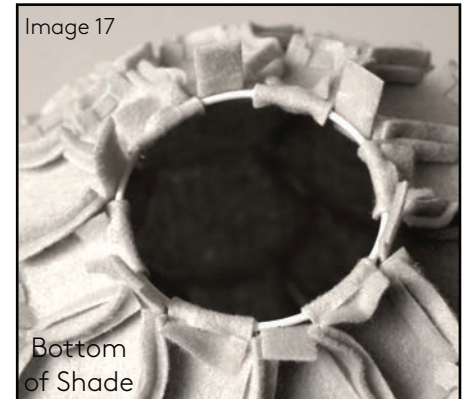
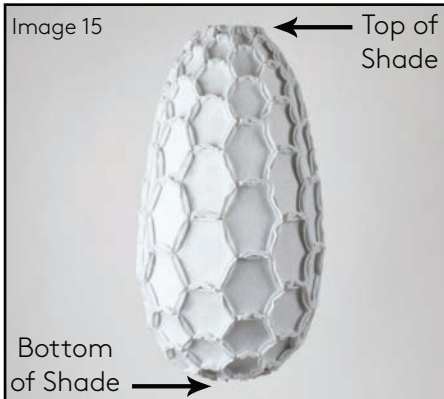

Now using a small wool needle or tweezers feed the small tongue over and under the ring and through the slot image 18. Once the tongue shows through the slot pull it through with your fingers or use the tweezers to pull it all the way through image 19. Do this on all of the remaining small tongues, when finished it will look like image 20.

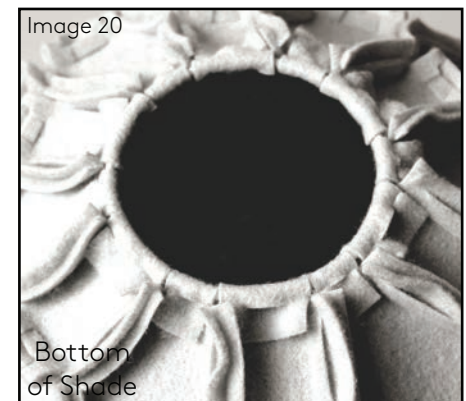

### Step 7

Flip the shade upright and repeat step 10 with the ring with the pendant ring with washer attachment on the top of the shade making sure that all 12 tongues are evenly spaced around the indent bar (total of six tongues on either side of pendant ring with washer attachment). Start with the large tongues first image 21 feed the tongue over and under the ring and through the slot. Once the large tongues are in place image 22 use your wool needle to feed all the small tongues through. It should look like image 23 when completed.

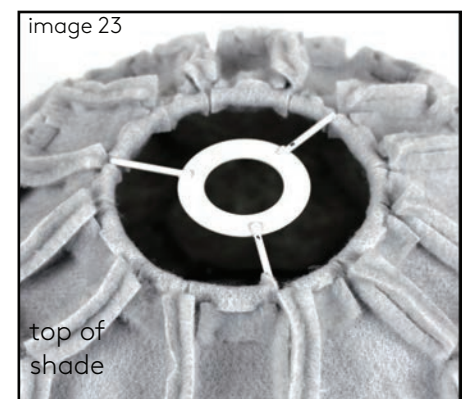

## Step 8

Now you can hang it from either a ceiling lamp holder image 24, or a hanging flex image252. Once hung you can insert your CFL (Compact Fluorescent Light) bulb. See first page of instructions for bulb recommendation.

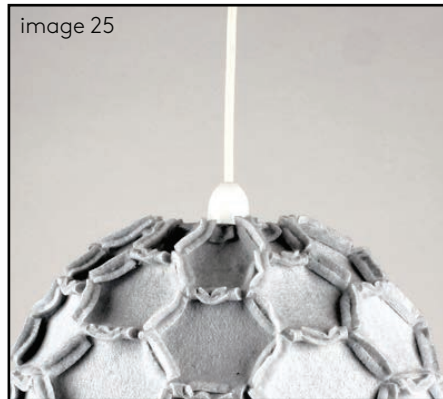

## Step 9

Finally let's put a bulb inside. Carefully undo four tongues down one seam image 26 to image 28 (between two vertical strips). From here you can insert your recommended bulb and reconnect the tongues. See first page of instructions for bulb recommendation. Congratulations now you can turn it on!

